

Motor Flanges

LinMot PF motor flanges enable easy mounting of linear motors. The clamping plate design enables quick assembly and disassembly of the linear motors without disassembling the flange.

A matching flange of the correct length is available for every family of linear motors. This not only ensures secure mechanical mounting, but also guarantees optimal cooling of the linear motor.



Flange



Flange with Fluid-Cooling

STATOR AND FLANGE MOUNTING

The same flange is used for stators with a cable output or a plug housing. The stator is secured in the flanges by means of clamping screws, so that the stator is clamped over a large surface area.

Clamping over a large surface area, practically the entire length of the stator, and the cooling fins on the flange, ensure optimal cooling of the linear motor.

Depending on the application and available space, the flanges can be installed horizontally with screws or vertically by means of the T-slots provided.

FLANGE WITH LIQUID COOLING

The heat losses generated in the motor are dissipated through the liquid cooling system. When the motor is operated with liquid cooling, the continuous rated power increases to a multiple of the self-cooled level.

FAN OPTION

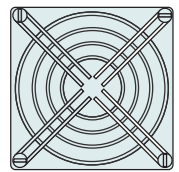
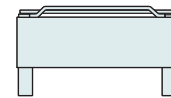

The optional fan can nearly double the effective force of the linear motor.

PF10-54x140

Max. torque for clamp
Plate screws: 12Nm

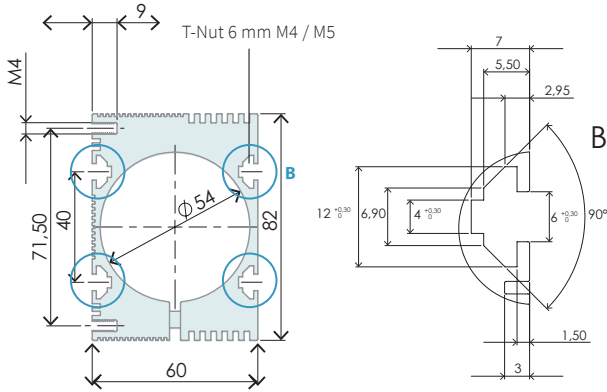
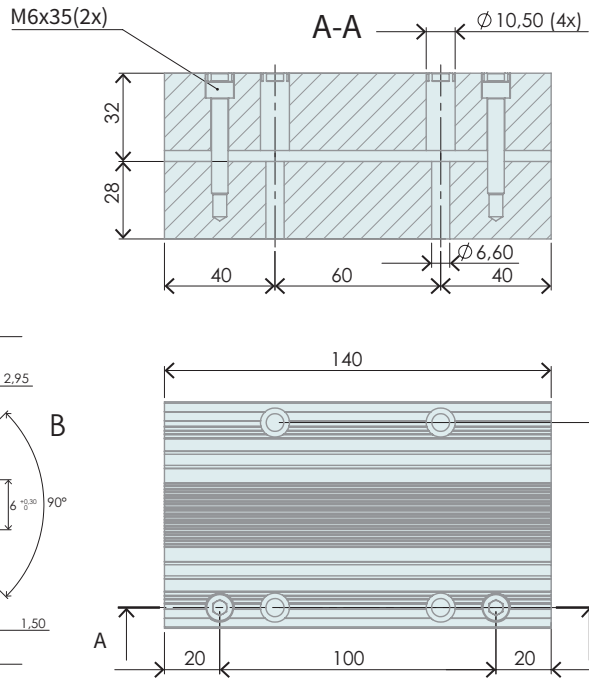

Item	Description	Stator type	Weight [g]	Item-No.
PF10-54x140	Flange for PS10-54x120	PS10-70x400	781	0150-2733

PF10-54x200

Max. torque for clamp
Plate screws: 12Nm

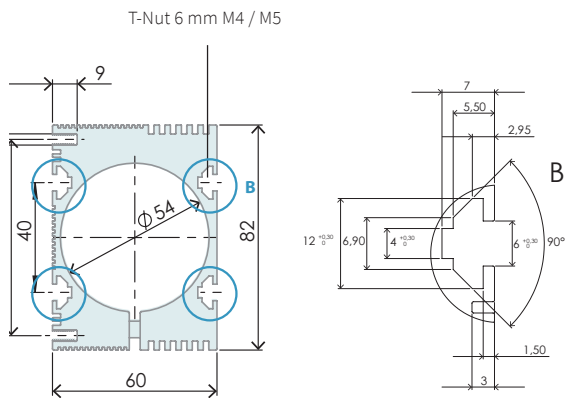
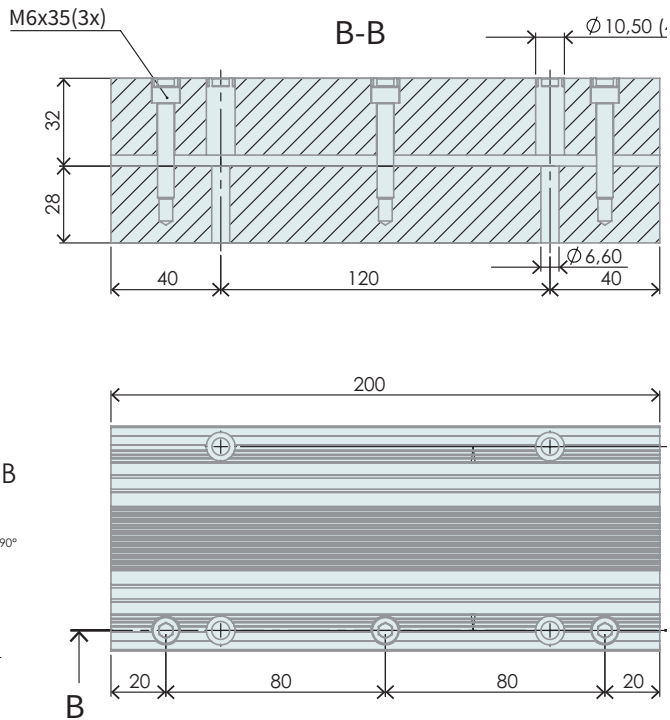

Item	Description	Stator type	Weight [g]	Item-No.
PF10-54x200	Flange for PS10-54x180	PS10-54x180	1132	0150-2734

PF10-54x260

Max. torque for clamp
Plate screws: 12Nm

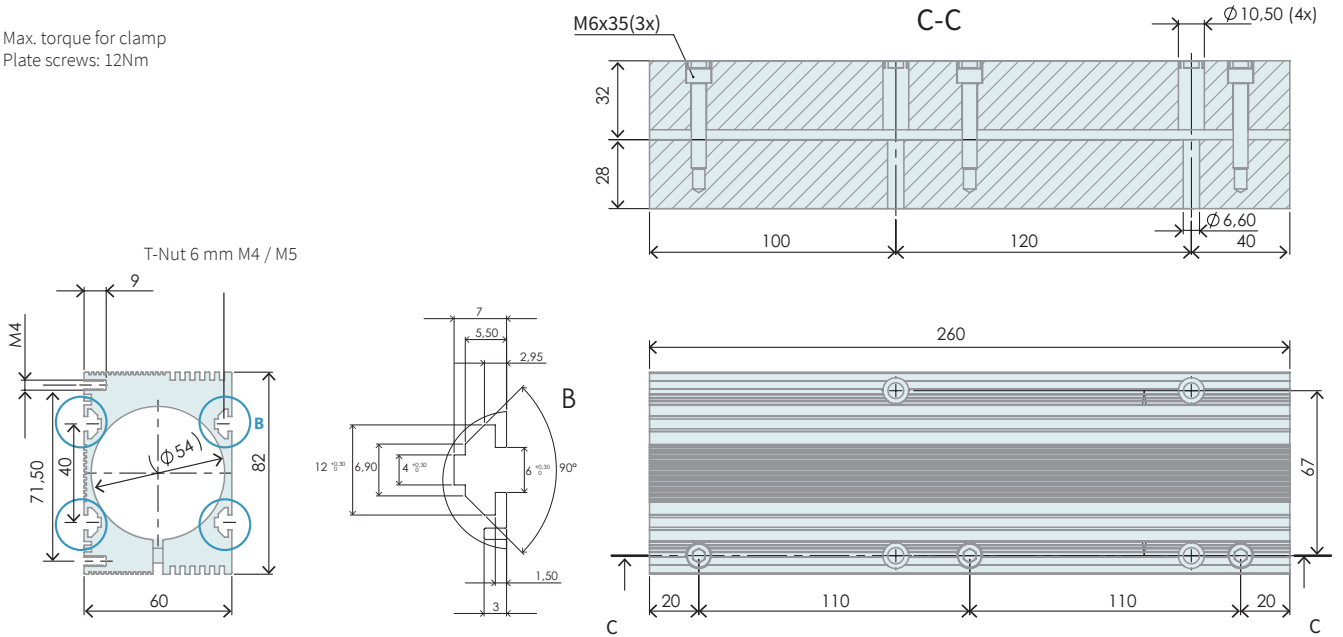

Item	Description	Stator type	Weight [g]	Item-No.
PF10-54x260	Flange for PS10-54x240	PS10-54x240	1475	0150-2735

PF10-54x320

Max. torque for clamp
Plate screws: 12Nm

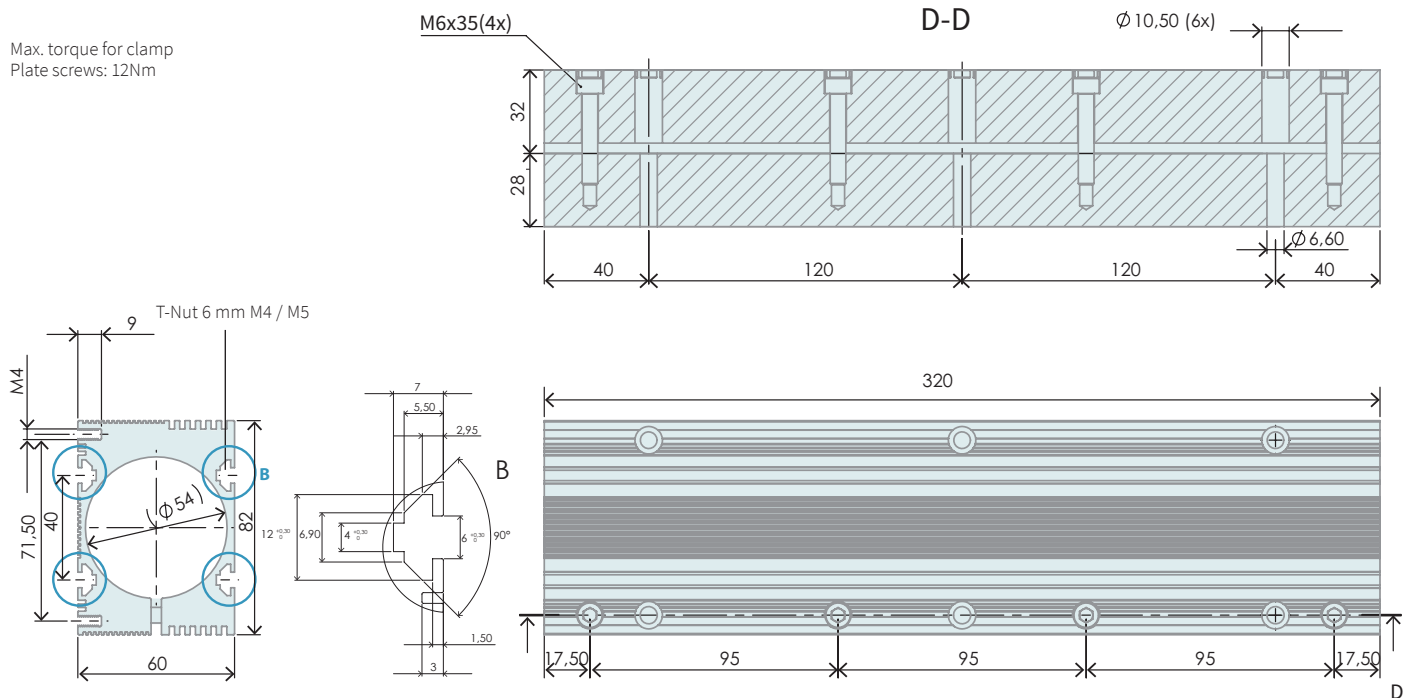

Item	Description	Stator type	Weight [g]	Item-No.
PF10-54x320	Flange for PS10-54x300	PS10-54x300	1809	0150-2736

PF10-70x110

Max. torque for clamp
Plate screws: 12Nm

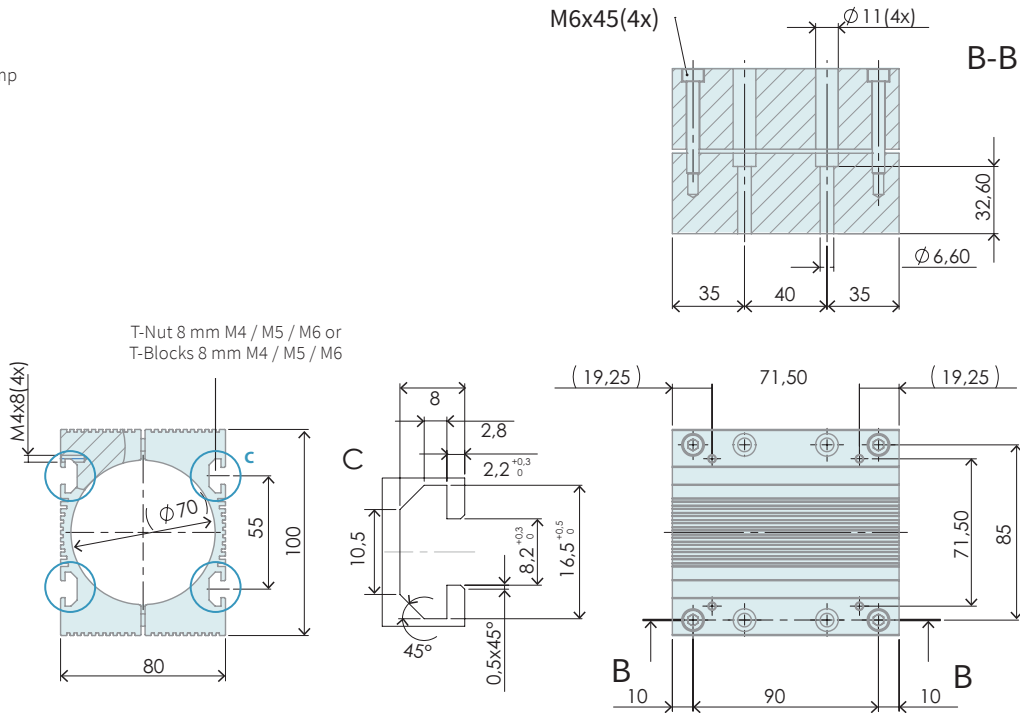

Item	Description	Stator type	Weight [g]	Item-No.
PF10-70x110	Flange for PS10-70x80	PS10-70x80	1015	0150-2272

PF10-70x190

Max. torque for clamp
Plate screws: 12Nm

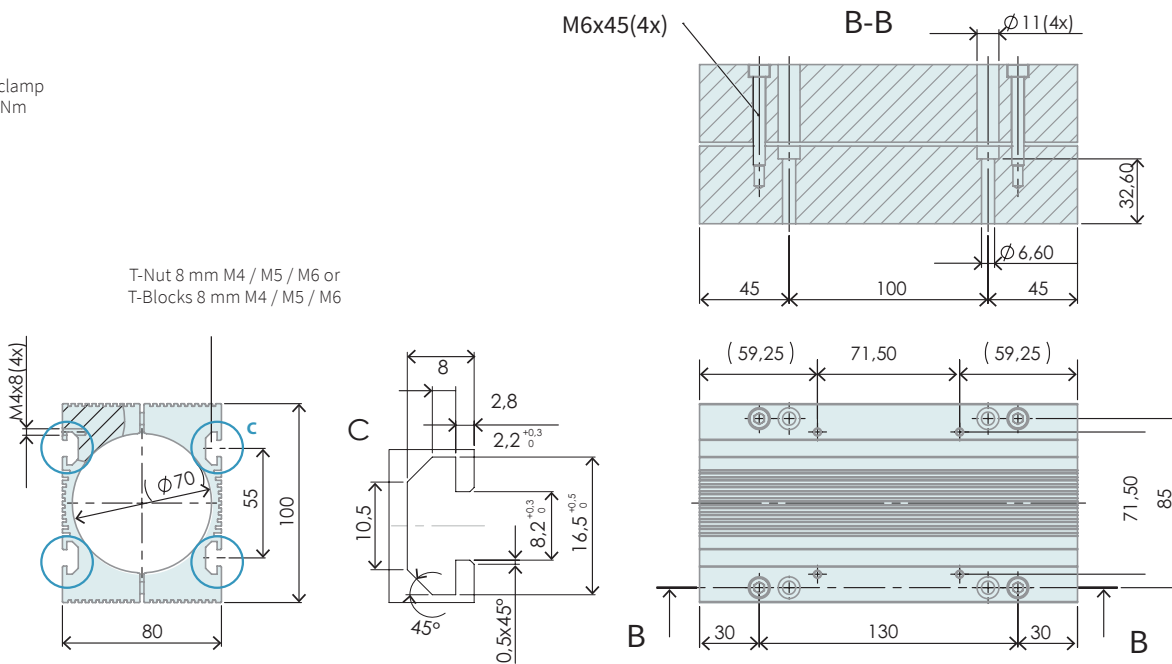

Item	Description	Stator type	Weight [g]	Item-No.
PF10-70x190	Flange for PS10-70x160	PS10-70x160	1776	0150-2273

PF10-70x270

Max. torque for clamp
Plate screws: 12Nm

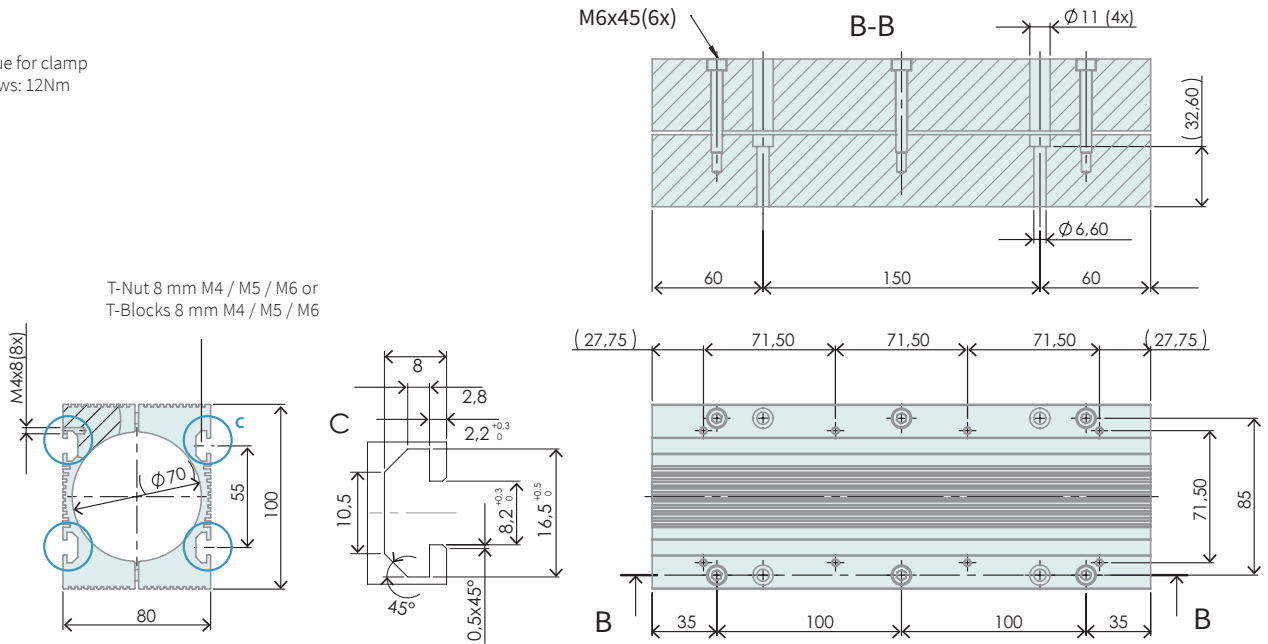

Item	Description	Stator type	Weight [g]	Item-No.
PF10-70x270	Flange for PS10-70x240	PS10-70x240	2550	0150-2274

PF10-70x350

Max. torque for clamp
Plate screws: 12Nm

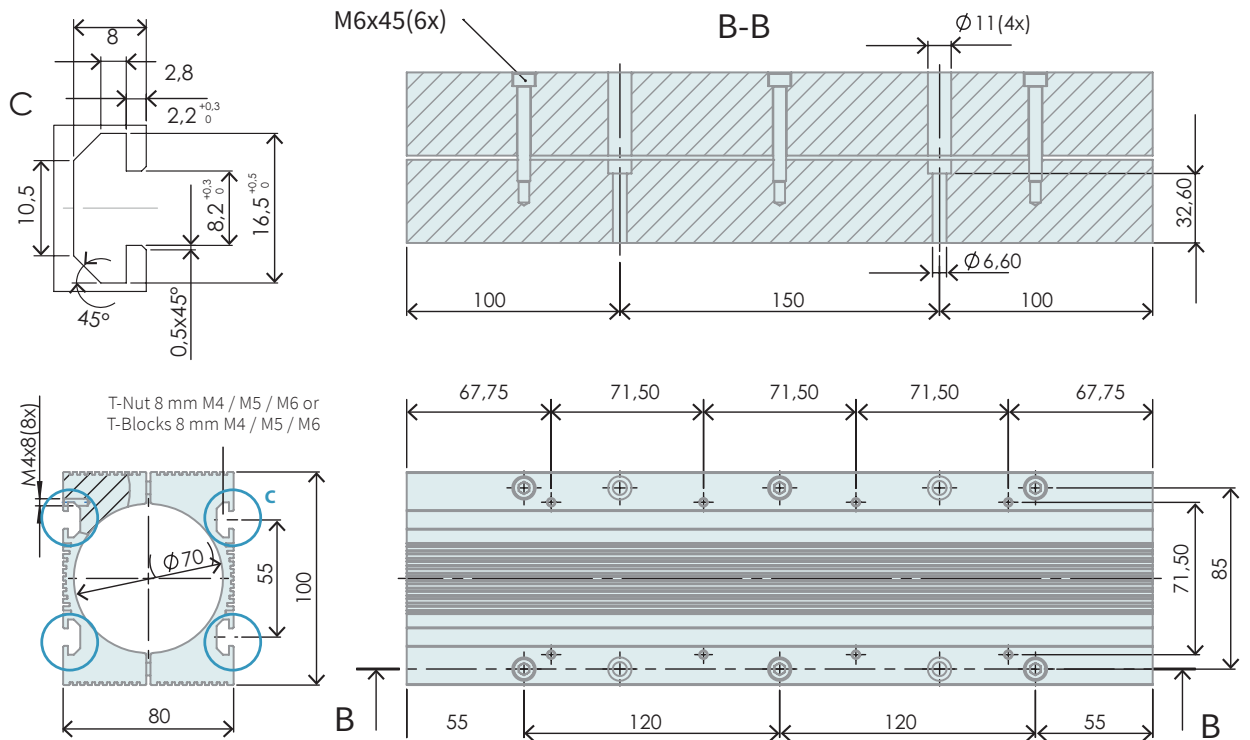

Item	Description	Stator type	Weight [g]	Item-No.
PF10-70x350	Flange for PS10-70x320	PS10-70x320	3311	0150-2290

PF10-70x430

Max. torque for clamp
Plate screws: 12Nm

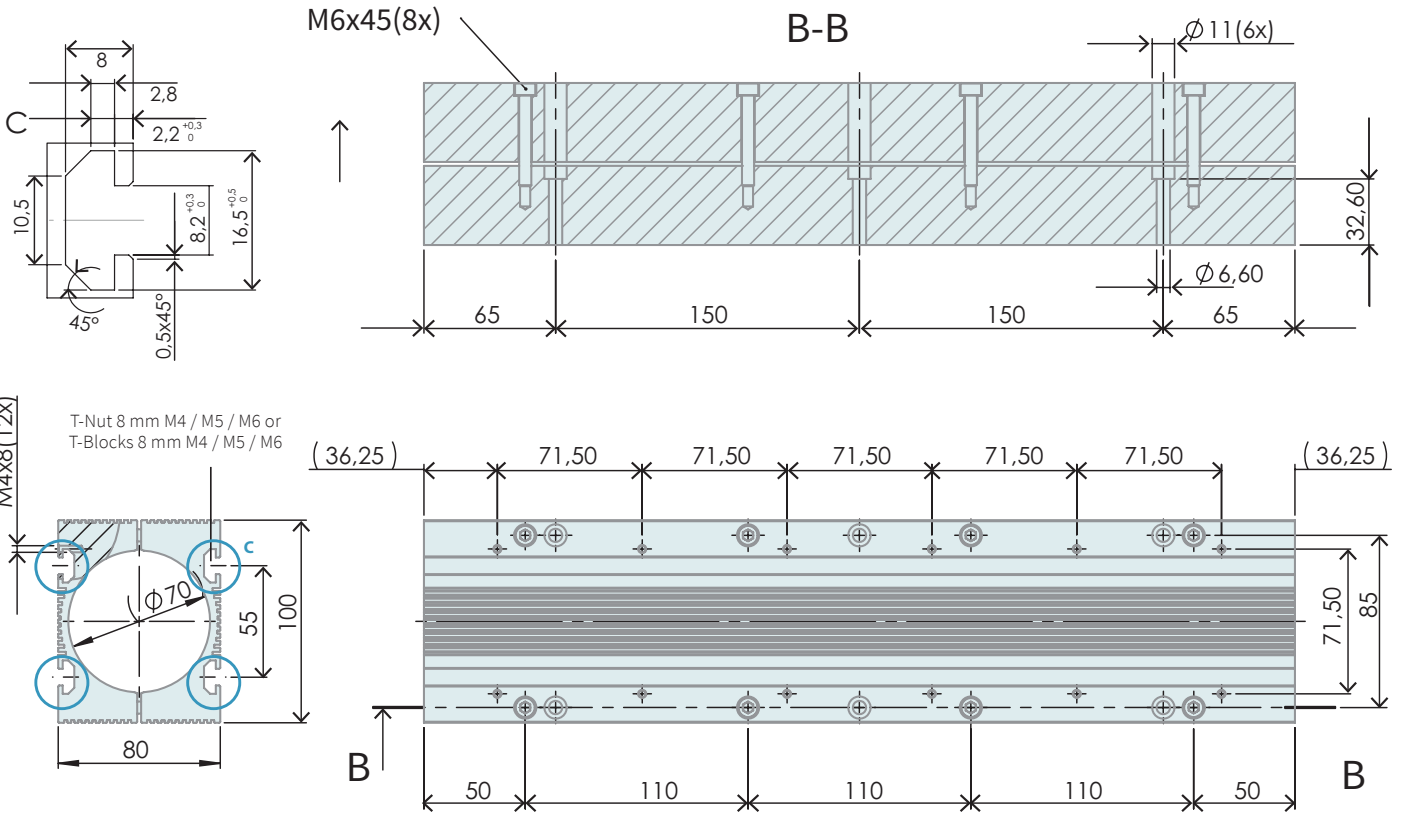

Item	Description	Stator type	Weight [g]	Item-No.
PF10-70x430	Flange for PS10-70x400	PS10-70x400	4056	0150-2276

OPTIONAL FAN FOR PF10-70

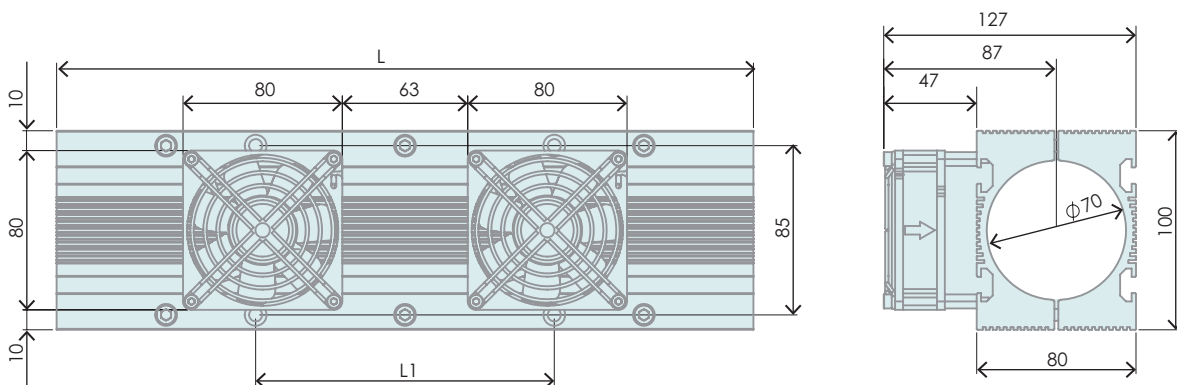

Fan supply: 24 VDC, 120 mA
Air flow: 80 m³/h

Item	Description	Item-No.
HV01-37/48	Fan kit for H10-70 and PF10-70	0150-5051

14

PF11-70x110-FC

Max. torque for clamp
Plate screws: 12Nm

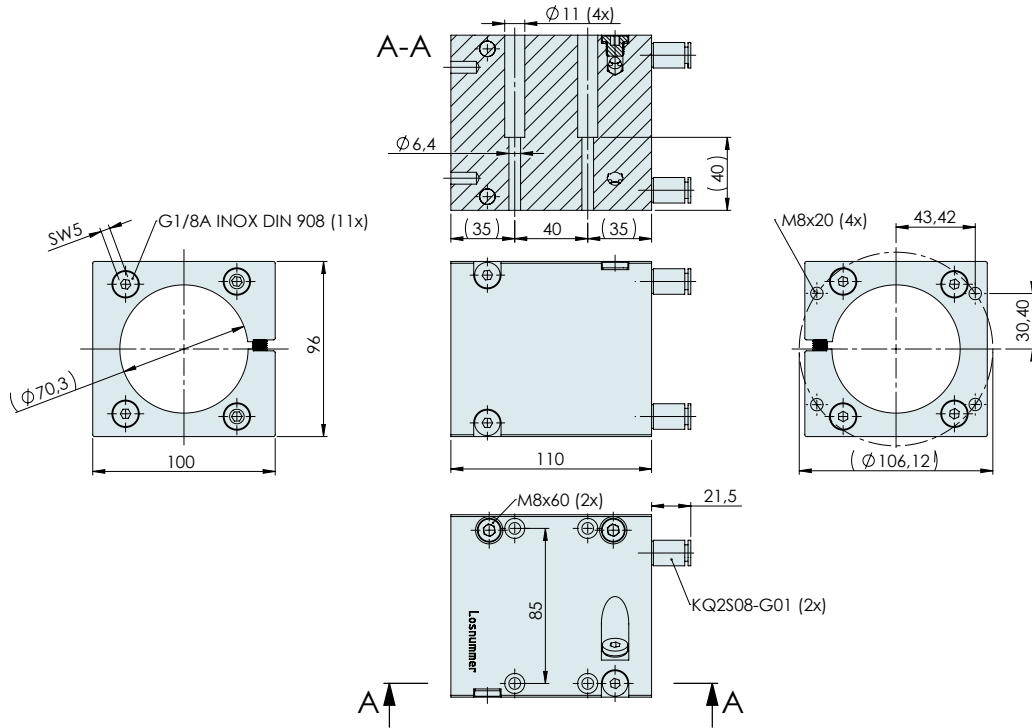

Item	Description	Stator type	Weight [g]	Item-No.
PF11-70x110-FC	Flange for PS10-70x80 fluid cooling	PS10-70x80	1641	0150-2822

PF11-70x190-FC

Max. torque for clamp
Plate screws: 12Nm

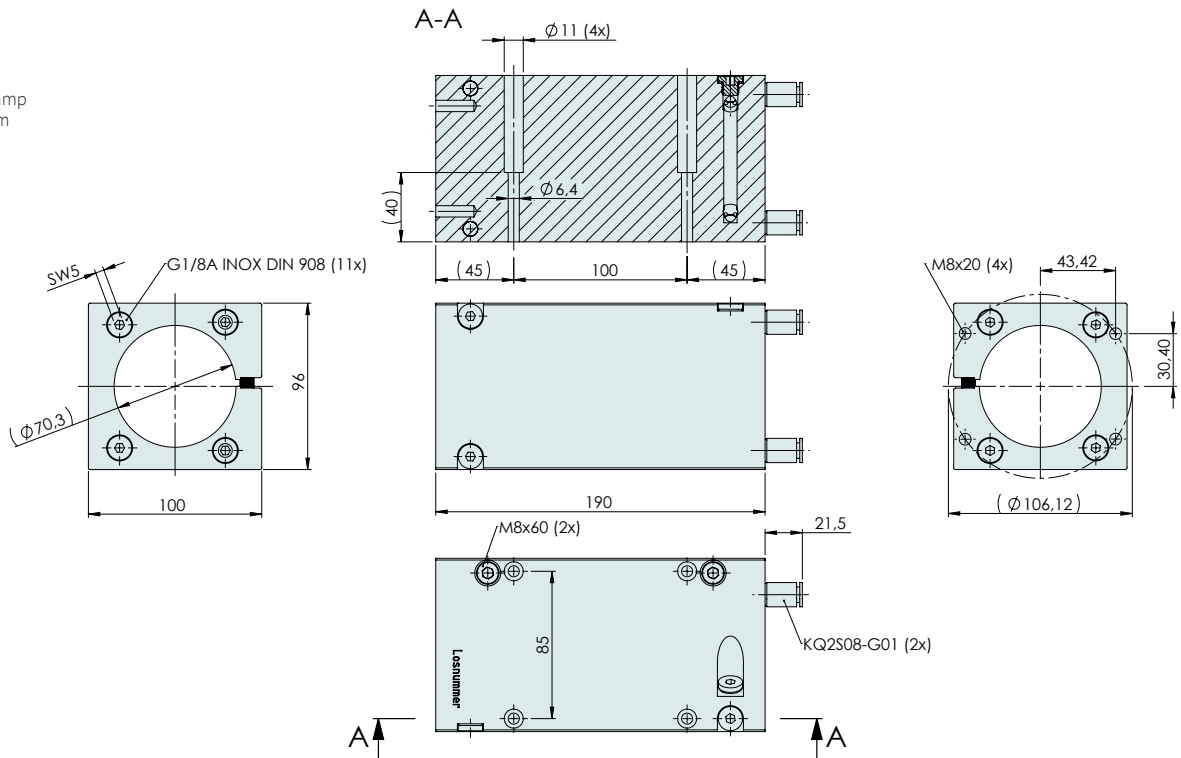

Item	Description	Stator type	Weight [g]	Item-No.
PF11-70x190-FC	Flange for PS10-70x160 fluid cooling	PS10-70x160	2825	0150-2823

PF11-70x270-FC

Max. Anzugsmoment für
Klemmplatzenschrauben: 12Nm

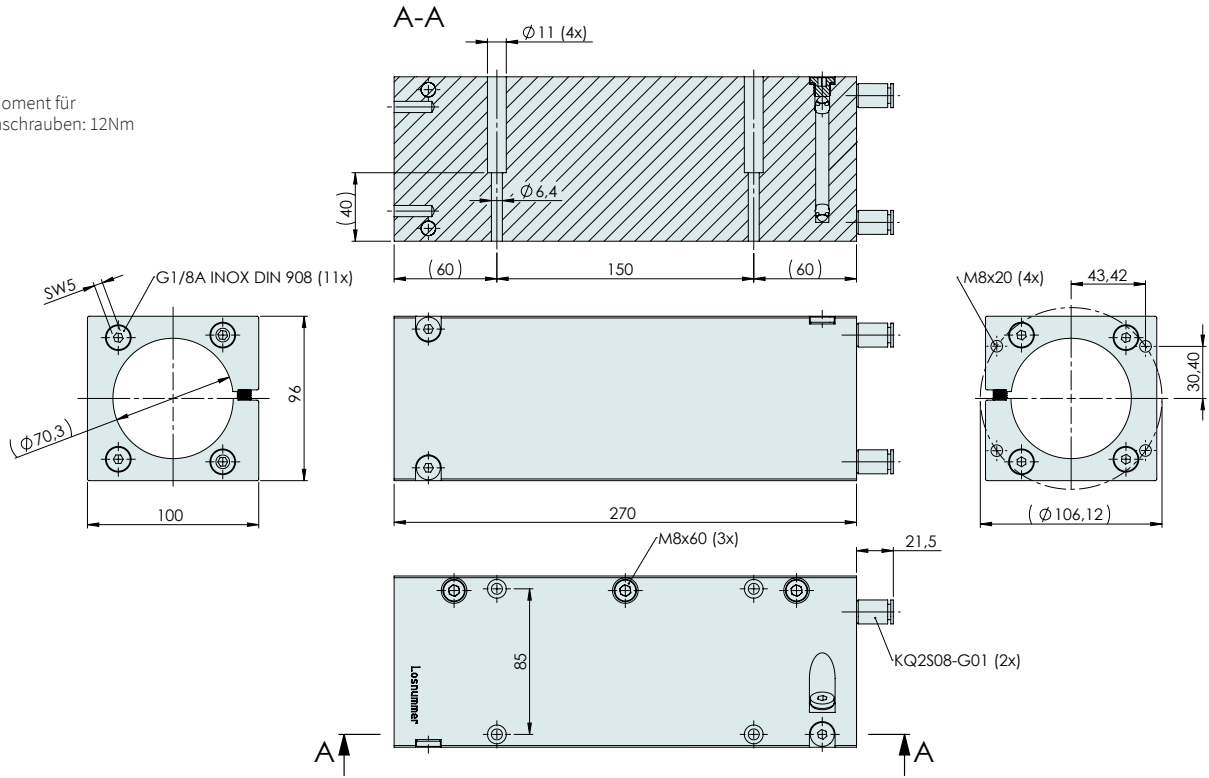

Item	Description	Stator type	Weight [g]	Item-No.
PF11-70x270-FC	Flange for PS10-70x240 fluid cooling	PS10-70x240	4000	0150-2824

PF11-70x350-FC

Max. torque for clamp
Plate screws: 12Nm

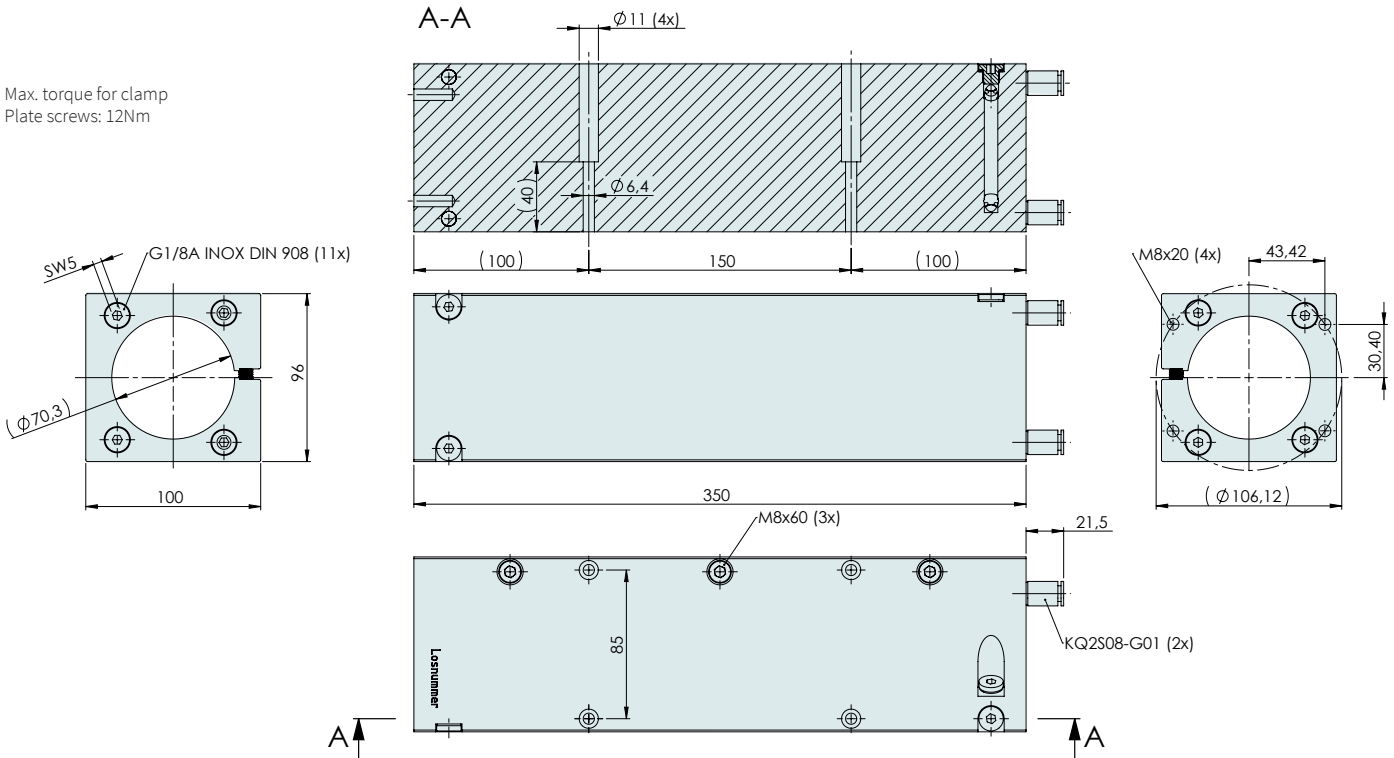

Item	Description	Stator type	Weight [g]	Item-No.
PF11-70x350-FC	Flange for PS10-70x320 fluid cooling	PS10-70x320	5185	0150-2825

14

PF11-70x430-FC

Max. torque for clamp
Plate screws: 12Nm

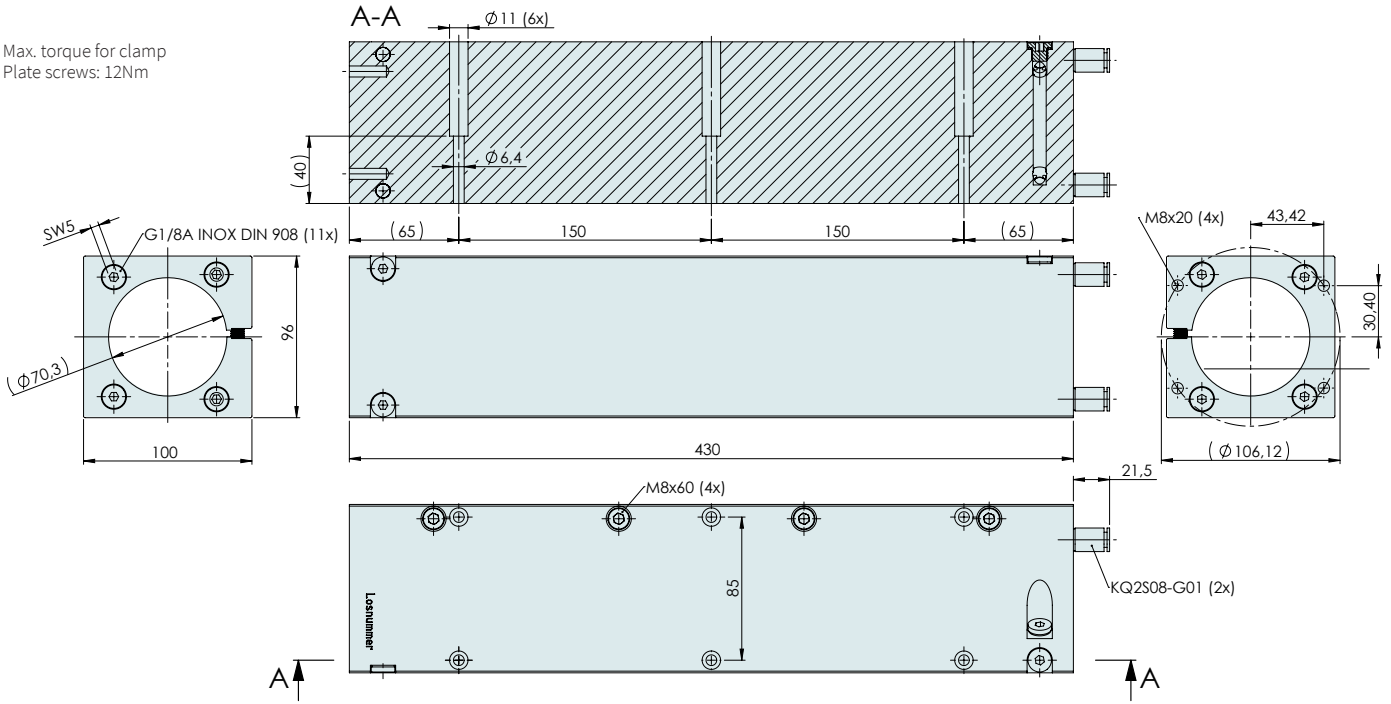

Item	Description	Stator type	Weight [g]	Item-No.
PF11-70x430-FC	Flange for PS10-70x400 fluid cooling	PS10-70x400	6325	0150-2826