

Mouse Pad

Can be installed in PC enclosures with keyboard drawer or shelf. Pulls out to right or left side (drawer) or front (shelf). Complete with self-adhesive pad covering and installation hardware.

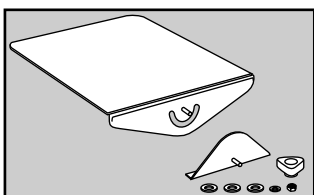
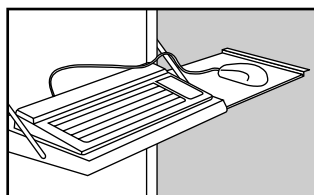

Mouse Pad Tray For Desk Consoles

Can be mounted on operator interface enclosures with a desk console (ie PC) or on other AP Series consoles for accommodation of SM 6444.000 and SM 6444.500 NEMA 6/IP 67 mouse pads. The slope of the mouse pad tray can be infinitely adjusted. Installation requires drilling two installation holes in the console.

Material: sheet steel, chromated
Configuration: mouse pad tray, installation hardware.

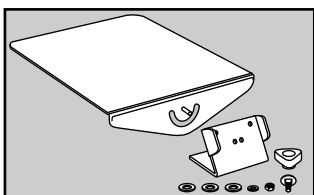

Mouse Pad Tray

Is mounted on vertical handles of keyboard housings for accommodation of SM 6444.000 and SM 6444.500 NEMA 6/IP 67 mouse pads. The slope of the mouse pad tray is infinitely adjustable. Installation requires drilling two installation holes in the handle grip brackets.

Material: sheet steel, chromated
Configuration: mouse pad tray, installation hardware.

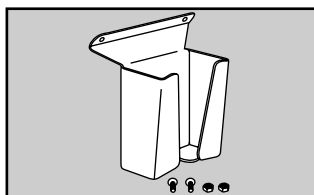

Mouse Holder

Fits Rittal mouse pad trays to ensure safe storage of a standard mouse or the Rittal SM 6445.000 NEMA 6/IP 67 mouse.

Material: sheet steel, chromated
Configuration: mouse holder, installation hardware.

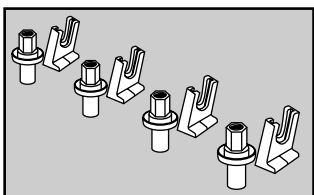

Mounting Kit For Threaded Bolts

For fastening:

- aluminum front panels with studs
- control panels with studs
- keyboards with studs.

Mouse Pad	
For enclosure	Part No.
PC fold-down with keyboard shelf	4613000
PC pull-out with keyboard drawer	4614000

Mouse Pad Tray For Desk Consoles		
For	Packs of	Part No.
PC 4603.704 AP Series consoles	1	2380000

Mouse Pad Tray		
Description	Packs of	Part No.
Mouse pad tray	1	2381000

Mouse Holder	
Packs of	Part No.
1	2382000

Mounting Kit For Threaded Bolts	
Thread	Part No.
M4	6058500
M5	6053500

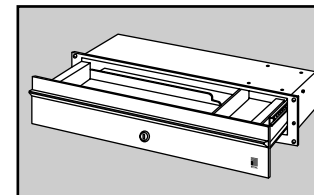

Keyboard Drawer 19"/2 U

Can be mounted in all 19" systems or on any sufficiently large surface (door, side wall, etc.). Its low weight (5.5 lbs/2.5 kg) makes it ideal for use in support arm systems because adequate room remains for cabling, even when the support arm is connected from below. It can also be locked with a 3524 E lock.

High mechanical protection and shielding is maintained, even when the drawer is open.

Technical data:

- Total available space: 15.35"x1.26"x5.47"/390x32x139 mm
- Drawer has 2.36"/60 mm high space on right for a mouse or trackball or for a 3-1/2" disk drive.
- When a mouse is used or when a 3-1/2" drive is installed, only enough space remains for an 11.2"/284 mm wide keyboard.

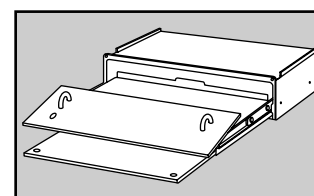

Keyboard Drawer With Mouse Pad

With 19"/3 U front panel for installation on all sufficiently large surfaces (door, side wall, etc.).

Technical data:

- Accepts keyboards up to HxWxD = 1.65"x18.11"x6.69"/460x42x170 mm
- Storage area for mouse under side of keyboard
- Front pull-out mouse pad.

Keyboard Drawer 19"/2 U			
Height	Width	Depth	Part No.
2 U	19"/482.6 mm	5.90"/150 mm	6002200

Material:

Frame: sheet steel, zinc-plated, chromated

Drawer housing and drawer: aluminum

Front panel and handle: aluminum, natural anodized

Configuration: Drawer housing with stops for 'open' position, front panel with handle, gasket and installation hardware.

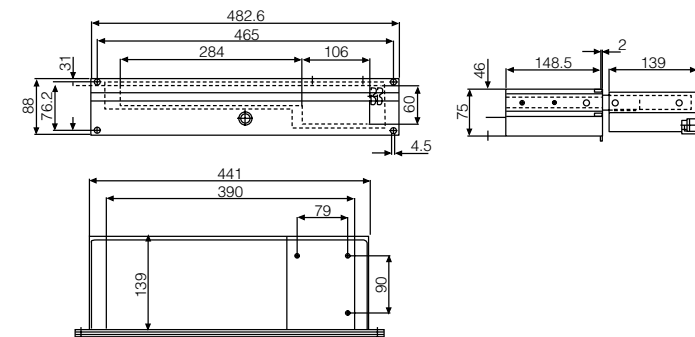

Keyboard Drawer With Mouse Pad			
Height	Width	Depth	Part No.
3 U	19"/482.6 mm	232 mm	6003000

Front panel:

- reversible, for track ball
- lockable, No. 3542 E insert
- features grip
- High protection rating and EMC shielding is maintained, even when drawer is open.

Material:

Mounting frame: steel, zinc-coated, chromated

Keyboard housing and tray: aluminum

Front panel and grip: aluminum, natural anodized.

Stainless Steel CP Accessories

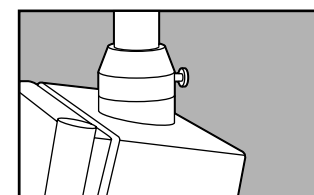

Tilting Adaptor, 10°, Stainless Steel

To adjust the enclosure tilt for increased user-friendliness. For mounting between:

- Housing coupling CP 6664000 and the Command Panel.

Configuration: Type 304 stainless steel, adaptor including seal and assembly parts. Not suitable for use as a base point for a support arm system.

Tilting Adaptor, 10°	
Weight	Part No.
1.5 lbs/0.7 kg	6664100

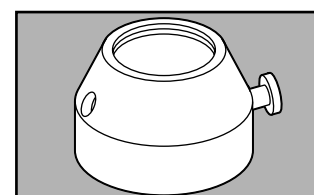
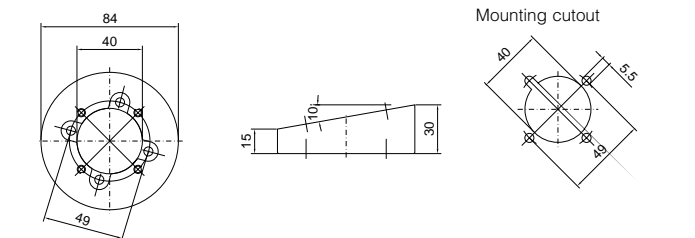

Enclosure Coupling, Rotating

For swivel mounting of the enclosure to the vertical part of the support arm system, with the enclosure either suspended or top-mounted.

Configuration: Rotation range approx. 350°. Type 304 stainless steel, including seals and assembly parts. Not suitable for use as a base point for a support arm system.

Supply includes:

- Enclosure coupling, 2 assembly screws for support section, 4 assembly screws for enclosure.

Enclosure Coupling, Rotating	
Weight	Part No.
2.4 lbs/1.1 kg	6664000

