

Interior installation

Mounting plates



Mounting plates

for KL

For component installation outside of the enclosure. Assembly screws included as accessories with the enclosure.

Material:

Sheet steel, 2 mm, zinc-plated, passivated



Accessories:

Self-tapping screws, SZ 2487.000, see page 1011.



Possible alternative:

Support rails, see page 1002.

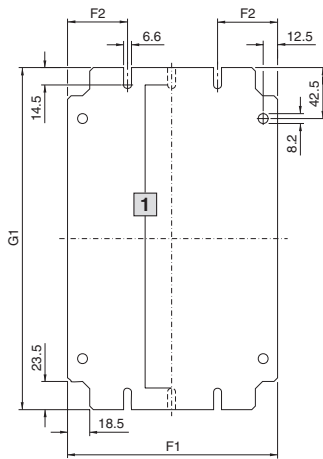

1 Attachment in the centre only for 125 mm wide plates

For size mm	For Model No. KL	Dimensions in mm			Model No. KL
		G1	F1	F2	
150 x 150	1500.510, 1514.510, 1521.010	135	125	–	1560.700
200 x 150	1528.510, 1529.510	185	125	–	1575.700
300 x 150	1501.510, 1515.510, 1522.010, 1530.510	285	125	–	1561.700
400 x 150	1589.510	385	125	–	1576.700
200 x 200	1502.510, 1516.510, 1523.010	185	175	50	1562.700
300 x 200	1503.510, 1517.510, 1524.010, 1531.510	285	175	50	1563.700
400 x 200	1504.510, 1518.510, 1525.010, 1532.510	385	175	50	1564.700
500 x 200	1505.510, 1533.510	485	175	50	1565.700
600 x 200	1506.510, 1519.510, 1534.510	585	175	50	1566.700
800 x 200	1527.510, 1542.510	785	175	50	1574.700
300 x 300	1507.510, 1526.010, 1535.510	285	275	50	1567.700
400 x 300	1508.510, 1536.510	385	275	50	1568.700
500 x 300	1509.510, 1537.510	485	275	50	1569.700
600 x 300	1510.510, 1538.510	585	275	50	1570.700
400 x 400	1511.510, 1539.510	385	375	62.5	1571.700
600 x 400	1512.510, 1540.510	585	375	62.5	1572.700
800 x 400	1513.510, 1541.510	785	375	62.5	1573.700

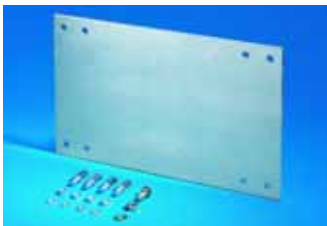

Mounting plate

for Premium Line KL

For installing at a distance from the rear panel.

Material:

Sheet steel, zinc-plated, passivated

Supply includes:

Spacer bolts and assembly parts.

For KL enclosures	W (B) mm	H mm	Packs of	Model No. KL
1024.010 1024.020	100	100	1	1024.910
1024.030	250	150	1	1024.920
1024.040	350	250	1	1024.930

Mounting plate attachment

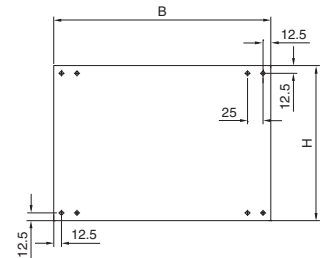
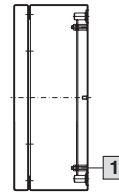

1 Spacer bolts M5 x 15