



## AZM300Z-I2-ST-AS

- Thermoplastic enclosure
- Repeated individual coding with RFID technology
- Coding level "High" according to ISO 14119
- Suitable for hinged and sliding guards
- 3 different directions of actuation
- Guard locking monitored
- Power to unlock
- Magnet supply through the AS-Interface
- hygienic design
- Protection class IP 69
- Solenoid interlock with integrated AS-i Safety Interface
- Universal repeatedly teachable or individual coding because of the RFID technology
- I-variants with coding level HIGH to ISO 14119
- 2 integrated snap-in stages

## Data

### Ordering data

Product type description	AZM300Z-I2-ST-AS
Article number (order number)	103005920
EAN (European Article Number)	4030661475219
eCl@ss number, version 12.0	27-27-26-03
eCl@ss number, version 11.0	27-27-26-03
eCl@ss number, version 9.0	27-27-26-03
ETIM number, version 7.0	EC002593
ETIM number, version 6.0	EC002593

## Approvals - Standards

Certificates	TÜV cULus ASi-SaW ECOLAB EAC FCC
--------------	---

## General data

Standards	EN IEC 62026-2 EN ISO 13849-1 EN ISO 14119 EN IEC 60947-5-1 EN IEC 61508
Coding	Individual coding, multiple teaching
Coding level according to EN ISO 14119	High
Working principle	RFID
Enclosure material	Glass-fibre, reinforced thermoplastic
Gross weight	605 g
Time to readiness, maximum	5,000 ms
Reaction time, maximum	120 ms
Duration of risk, maximum	200 ms

## General data - Features

Power to unlock	Yes
Solenoid interlock monitored	Yes
Latching	Yes
Manual release	Yes
Safety functions	Yes
Integral system diagnostics, status	Yes
Number of actuating directions	3

## Safety classification

Standards	EN IEC 61508
Performance Level, up to	e
Category	4
PFH value	$4.00 \times 10^{-10}$ /h
PFD value	$7.00 \times 10^{-5}$
Safety Integrity Level (SIL), suitable for applications in	3
Mission time	20 Year(s)

## Mechanical data

Mechanical life, minimum	1,000,000 Operations
Note (Mechanical life)	When using as door stop: $\geq 50.000$ operations (door mass $\leq 5$ kg and actuating speed $\leq 0.5$ m/s)
Holding force	1,150 N
Latching force, adjustable, position 1	25 N
Latching force, adjustable, position 2	50 N

## Mechanical data - Switching distances according EN IEC 60947-5-3

Assured switching distance "ON" $S_{ao}$	1 mm
Assured switching distance "OFF" $S_{ar}$	20 mm
Switch distance, typical	2 mm

## Mechanical data - Connection technique

Termination	Connector plug M12, 4-pole, (A-coding)
-------------	--

## Mechanical data - Dimensions

Length of sensor	34.4 mm
Width of sensor	87.4 mm
Height of sensor	102.6 mm

## Ambient conditions

Degree of protection	IP67 IP69K IP66
Ambient temperature, minimum	+0 °C
Ambient temperature, maximum	+60 °C
Storage and transport temperature, minimum	-10 °C
Storage and transport temperature, maximum	+90 °C
Resistance to vibrations	10 ... 150 Hz, amplitude 0.35 mm
Resistance to shock	30 g / 11 ms
Protection class	II

## Ambient conditions - Insulation values

Rated insulation voltage $U_i$	32 VDC
Rated impulse withstand voltage $U_{imp}$	0.8 kV
Overvoltage category	III
Degree of pollution	3

## Electrical data - AS Interface

AS-i Operating voltage, minimum	26.5 VDC
AS-i Operating voltage AS-i maximum	31.6 VDC
Note (AS-i Operating voltage)	Protection against polarity reversal
AS-i Current consumption, maximum	200 mA

## Electrical data - AS-Interface specification

AS-i Specification	Safety-Slave
AS-i Version	V 3.0
AS-i Profile	S-7.B.F.E
AS-i Input, Channel 1	Data bits DI 0 / DI 1 = dynamic code transmission
AS-i Input, Channel 2	Data bits DI 2 / DI 3 = dynamic code transmission
AS-i Outputs, DO 0	Solenoid control
AS-i Outputs, DO 1	No Function
AS-i Outputs, DO 2	No Function
AS-i Outputs, DO 3	No Function
AS-i Parameter bits, P0	Safety guard closed and can be locked
AS-i Parameter bits, P1	Solenoid interlock locked
AS-i Parameter bits, P2	Auxiliary voltage in
AS-i Parameter bits, P3	Internal device error (FID)
Note (AS-i Parameter bits)	Set the parameter outputs to "1111" (0xF) FID: periphery error
AS-i Input module address	0
Note (AS-i Input module address)	Preset to address 0, can be changed through AS-interface bus master or hand-held programming device

## Status indication



(3)

**without**

Power to unlock

**A**

Power to lock

(4)

**without**

Magnet supply from AS-Interface

**P**

Magnet supply 24 VDC (AUX)

(5)

**without**

Manual release

**N**

Emergency release

**T**

Emergency exit

**T8**

Emergency exit, distance 8.5 mm

## Pictures

### Product picture (catalogue individual photo)



ID: kazm3f26

| 905.6 kB | .jpg | 352.425 x 440.619 mm - 999 x 1249 px - 72 dpi

| 59.1 kB | .png | 74.083 x 92.428 mm - 210 x 262 px - 72 dpi

### Dimensional drawing basic component

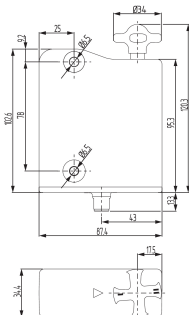

ID: kazm3g02

| 7.1 kB | .png | 73.731 x 125.589 mm - 209 x 356 px - 72 dpi

| 163.3 kB | .jpg | 352.778 x 599.369 mm - 1000 x 1699 px - 72 dpi

Schmersal, Inc., 15 Skyline Drive, Hawthorne, NY 10532

The details and data referred to have been carefully checked. Images may diverge from original. Further technical data can be found in the manual. Technical amendments and errors possible.

Generated on: 12/13/2022, 6:22 AM