



eurofast® Reverse Key Receptacles, Front Mount

- Used in AC and Special Applications
- Front Mount for Use in Distribution Panels, Junction Boxes and Sensors
- Available with Leads or Solder Cups
- Machined from Solid Brass
- Locknuts and O-rings Included



See table below

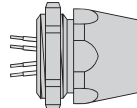

FKW..

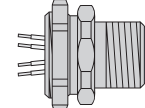

FSW..

PG 9 Threads, Leads and Solder Cups; 5-pin

| Application | Specifications | Pinout | Female | Male |
|---|--|--|-------------|-------------|
| 5-conductor, mates with reverse key cordsets, Leads UL Recognized CSA Certified | 4/22 AWG 1/20 AWG leads 250 V 4.0 A | 1. Bn 2. Wh 3. Bu 4. Bk 5. Gn/Ye | FKW 4.5-0.5 | FSW 4.5-0.5 |
| 5-conductor, mates with reverse key cordsets Solder Cups | Solder cups accept 20 AWG max leads 250 V 4.0 A | --- | FKW 4.5 | FSW 4.5 |

1/2-14 NPSM Threads, Leads; 5-pin

| Application | Specifications | Pinout | Female | Male |
|---|--|--|--------|------------------|
| 5-conductor, mates with reverse key cordsets, Leads UL Recognized CSA Certified | 4/22 AWG 1/20 AWG leads 250 V 4.0 A | 1. Bn 2. Wh 3. Bu 4. Bk 5. Gn/Ye | --- | FSW 4.5-0.5/14.5 |

Rotating Coupling Nut, PG 9 Threads, Leads; 5-pin

| Application | Specifications | Pinout | Female | Male |
|---|--|--|--------------|------|
| 5-conductor, mates with reverse key cordsets, Leads UL Recognized CSA Certified | 4/22 AWG 1/20 AWG leads 250 V 4.0 A | 1. Bn 2. Wh 3. Bu 4. Bk 5. Gn/Ye | FKMW 4.5-0.5 | --- |

Front Locknut, PG 9 Threads, Leads; 5-pin

| Application | Specifications | Pinout | Female | Male |
|---|--|--|--------------|--------------|
| 5-conductor, mates with reverse key cordsets, Leads UL Recognized CSA Certified | 4/22 AWG 1/20 AWG leads 250 V 4.0 A | 1. Bn 2. Wh 3. Bu 4. Bk 5. Gn/Ye | FKDW 4.5-0.5 | FSDW 4.5-0.5 |

Specifications

| | |
|-------------------------|--|
| Housing: | Nickel plated brass, machined from solid stock. See options below**. |
| Contact Carrier: | Oil resistant Nylon or PUR. Spacings to VDE 0110 Group C. |
| Contacts: | Gold plated brass. |
| Lock Nuts: | Nickel plated brass. |
| Leads: | Flexible stranding, PVC insulation. |
| Temperature: | -30°C to +80°C (-22°F to +176°F). |
| Protection: | NEMA 1,3,4,6P and IEC IP 68. |

- ** Options:** The following receptacles are offered in stainless steel:
PG 9 or 1/2-14 threads - male & female. Does not include Rotating or Front Locknut.
- Notes:** PG 9 receptacles require 5/8" (16 mm) hole for panel mounting.
1/2-14 receptacles require 13/16" (21.0 mm) hole for panel mounting.
O-ring included.

Dimensions

FKW 4.5-0.5

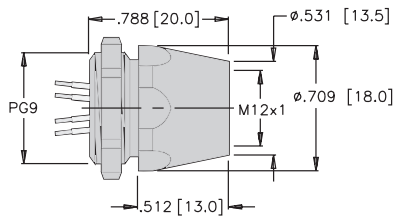

Female, Leads

FKW 4.5

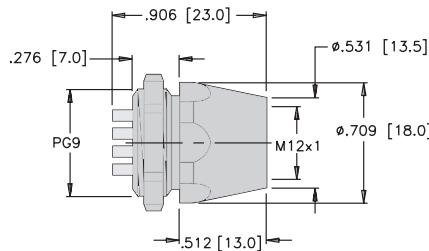

Female, Solder Cup

FKDW 4.5-0.5

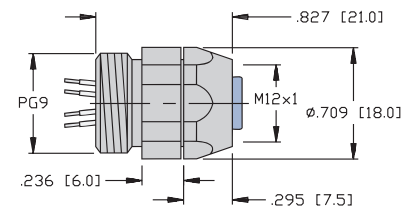

Female, Leads

FSW 4.5-0.5

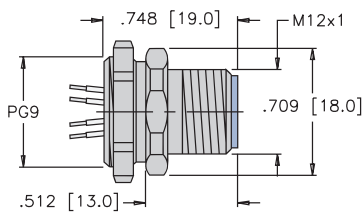

Male, Leads

FSW 4.5

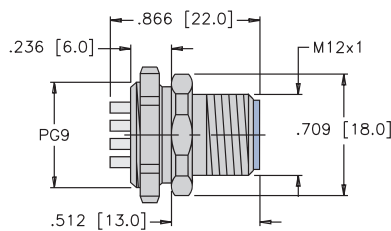

Male, Solder Cup

FSDW 4.5-0.5

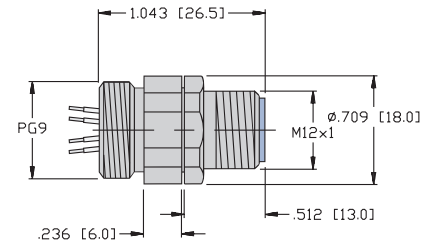

Male, Leads

FSW 4.5-0.5/14.5

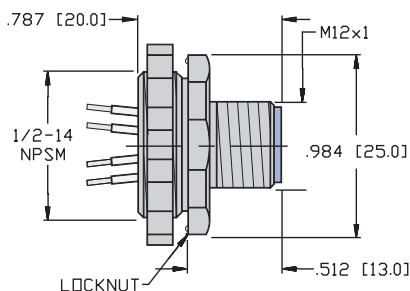

Male, Leads

Pinouts

| Female | Male |
|------------------------|------------------------|
| | |
| 5-pin (Reverse) | 5-pin (Reverse) |

FKMW 4.5-0.5 with leads

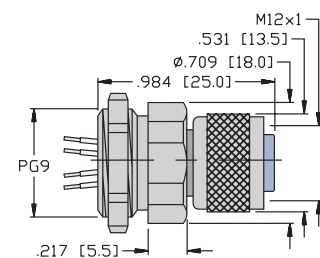

Female, Leads