

4 and 5-Pin Circuit Board Mounted Receptacles



- NEMA 1, 3, 4, 6P
- IEC IP68 Protection
- 250 V, 4 A



Housing Style	Female Part Number	Male Part Number	Features	Pinout
<p>FK..PCB</p>	FK 4.5-PCB	FS 4.5-PCB	105°C, mates with 5-pin cordsets, nickel plated brass housing material	<p>Female</p> <p>Male</p>
<p>FS..-PCB</p>	FKFDH 4.4	FSFDH 4.4	105°C, mates with 4-pin cordsets, separate housing and contact carrier, nickel plated brass housing material	<p>Female</p> <p>Male</p>
<p>FKFDH..</p> <p>Typical panel cutout is 15.3 mm x 14 mm</p>	FKFDH 4.5	FSFDH 4.5	105°C, mates with 5-pin cordsets, separate housing and contact carrier, nickel plated brass housing material	<p>Female</p> <p>Male</p>
<p>FSFDH..</p> <p>Typical panel cutout is 15.3 mm x 14 mm</p>	FKFDH 4.5	FSFDH 4.5	105°C, mates with 5-pin cordsets, separate housing and contact carrier, nickel plated brass housing material	<p>Female</p> <p>Male</p>

FKFDH - Detail

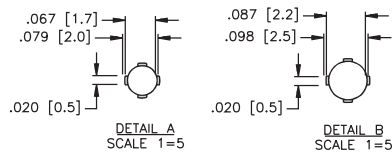

FSFDH - Detail

