

Device Gland Receptacles

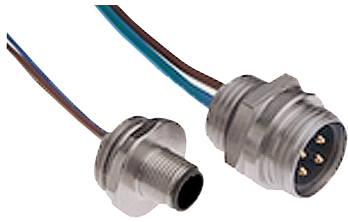

Selection Guide	eurofast®	minifast®
1/2 - NPT	FSV 57-*M / 14.5	RSFV 57-*M / 14.5
M20	FSV 57-*M / M20	RSFV 57-*M / M20

FSV 57-*M / 14.5

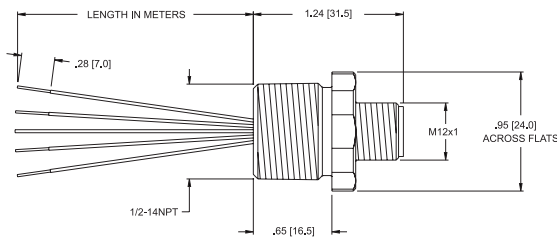

FSV 57-*M / M20

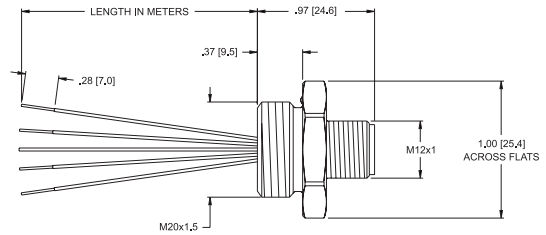

RSFV 57-*M / 14.5

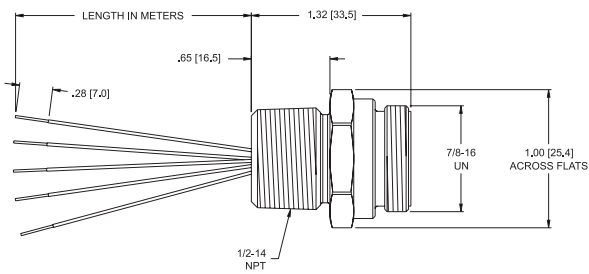

RSFV 57-*M / M20

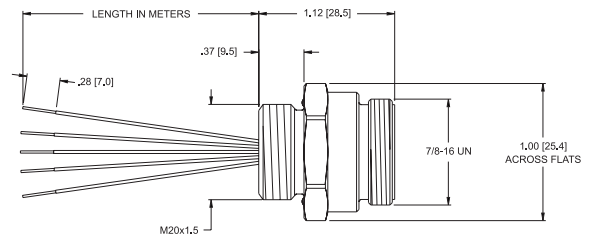

Male minifast®

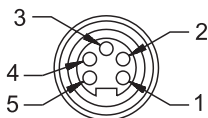

1. Grey (Shield)
2. Red (+ Voltage)
3. Black (- Voltage)
4. White (CAN_H)
5. Blue (CAN_L)

Male eurofast®

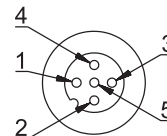

* indicates cable length.
Consult factory for availability of nickel plated brass.