

# ERKVG-A4.400.2-1

## Actuator and Sensor Receptacle – Rear Mount

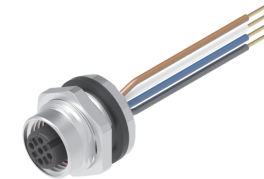
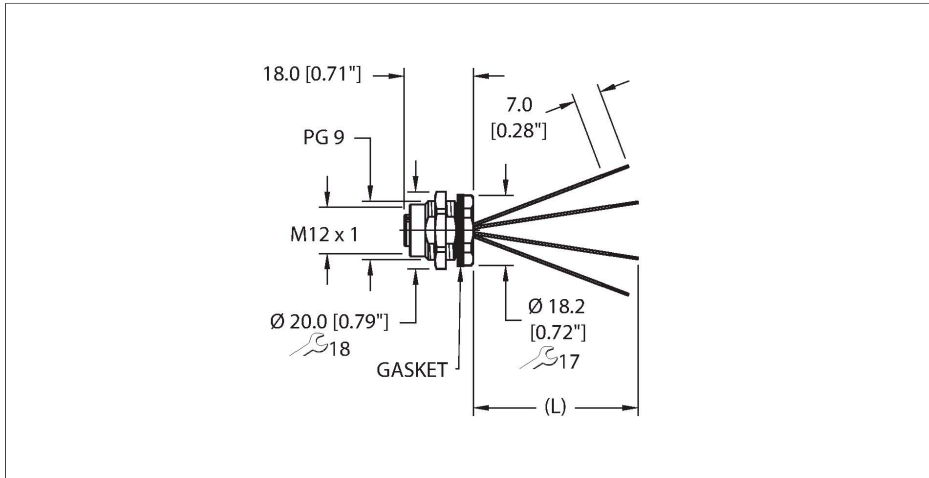

### Technical data

Type	ERKVG-A4.400.2-1
ID	100007266
Replaces	FKFDV 4.4-x
Connector A	Female, M12 × 1, A-code
Design specification	Acc. to IEC 61076-2-101
Number of contacts	4
Contacts	Bronze, CuSn, Gold-plated
Contact carriers	Plastic, TPU, Black
Connector seal	O-ring, FKM/FPM
Housing material/finish	Brass, CuZn, Nickel-plated
Tightening torque (range)	0.4 ... 1.8 Nm (note max. torque of mating connector!)
Mounting orientation	Rear mount
Panel seal	Gasket, NBR
Mounting thread	PG9
Locknut	Brass, CuZn, Nickel-plated
Receptacle mounting torque	2.5...6.8 Nm
Mechanical life	> 100 Mating cycles
Pollution degree	3
Protection class (When coupled)	IP67, IP68, IP69, IP69K NEMA: 1, 3, 4, 4X, 6P, 12
<b>Conductor data</b>	
Total number of conductors	4

### Features



- M12, Female, Receptacle, Rear mount, 4-pin
- Mounting thread: PG9

### Contact assignment

Connector A

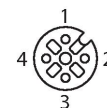

### Circuit Diagram





Accessories

**LOCKNUT-PG9-316SS-(10/BAG)**

**A9583**

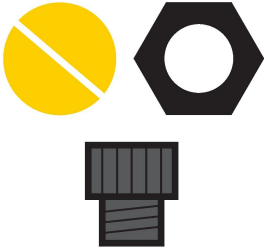

Locknut, PG9, 316 Stainless Steel, 10 per bag

**FK(S)FD-TOOL**

**A2550**

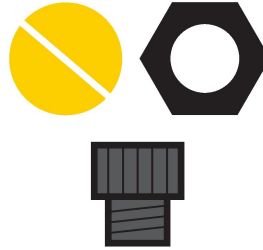

Tool, knockout hole punch, receptacle-mounting hole. Accommodates PG9 threads.

**DECAL,9-CLRS,RECEPT+BOXES,EURO(QTY1)**

**100008955**

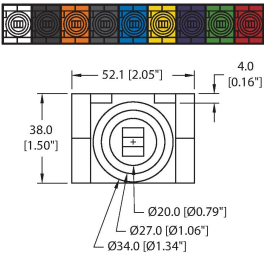

1 decal sticker containing 9 different color sets of 11 decals to color code a sensor, junction block port, cable end, or receptacle. 5ct 4x9mm rectangles, 4ct 8x19mm rectangles, 1ct 27mm ID ring, 1ct 20mm ID ring.

**ORING-Ø7x1.5-M12-(10/BAG)**

**100024937**

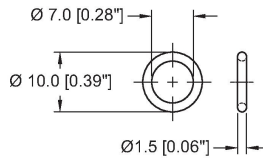

10 pack of Ø7x1.5 FKM O-rings for female M12 connectors

Accessories

**M12-GASKET-PG9,M16,1/4NPT-(10/BAG)**

**100015009**

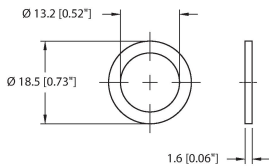

Gasket, Black NBR, Fits PG9, M16 and 1/4NPT mounting threads, 10 per bag